

Advanced Engineering

Epoch21

Nano-PVD Coating
TH45+

MMC Hitachi Tool

No. 408.2

EPHT Epoch Hard TH Coating

EPBT Epoch Ball TH Coating

High Speed Direct Milling of Hardened Steels

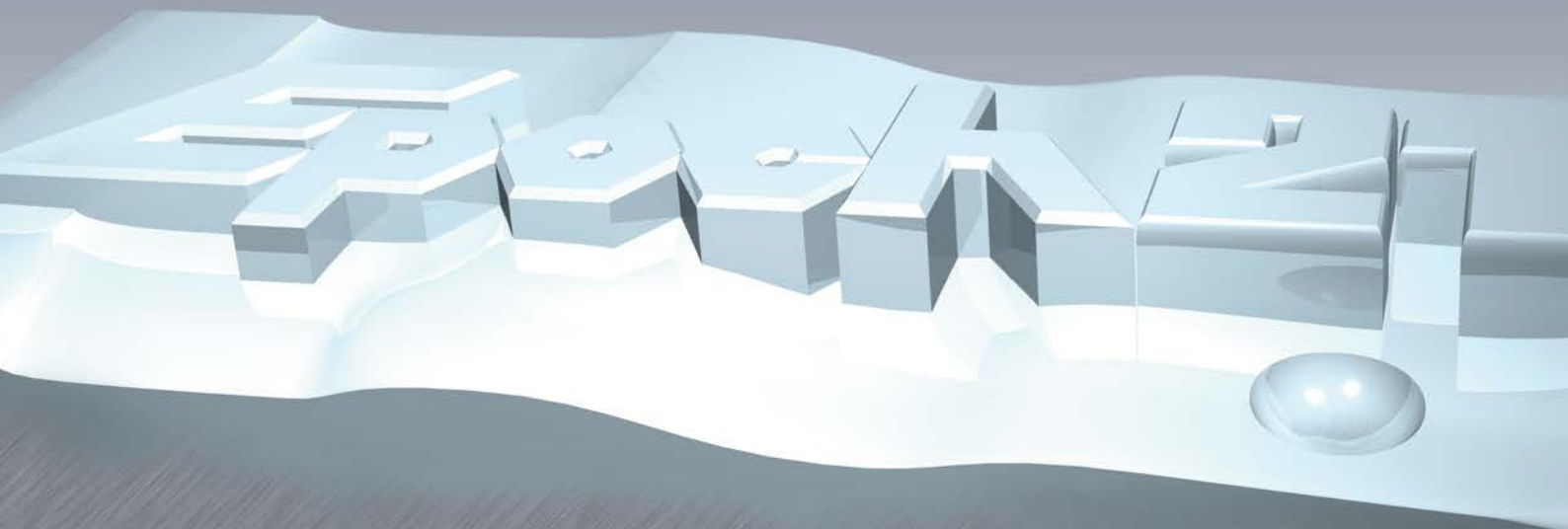
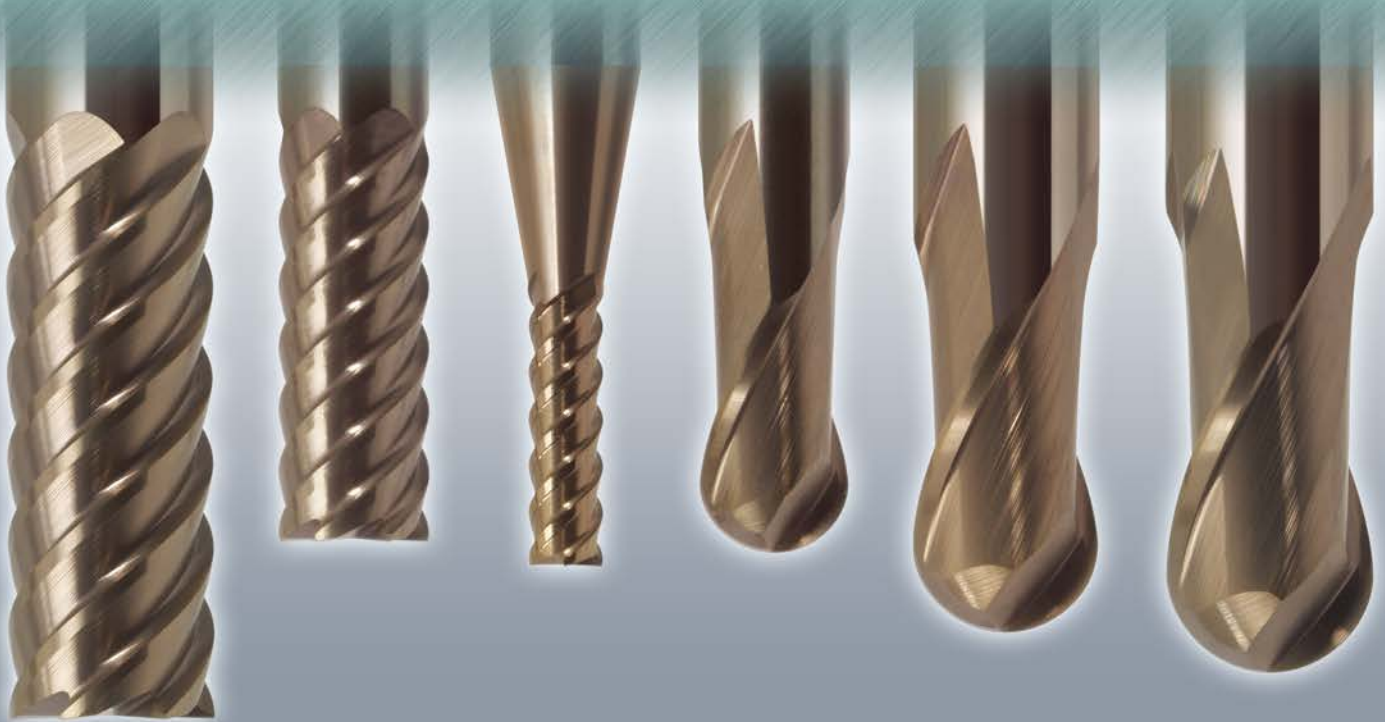

MMC Hitachi Tool Engineering Europe GmbH
www.high-speed-cutting.com



Nano-PVD Technology

EPBT | Epoch Ball TH-Coating

V max High Speed	▽ Roughing	▽▽ Semi-Finishing	▽▽▽ Finishing	HRC 70	No. of Teeth 2
----------------------------	----------------------	-----------------------------	-------------------------	------------------	--------------------------

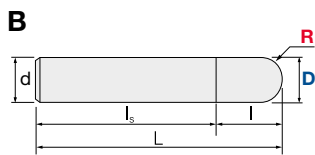
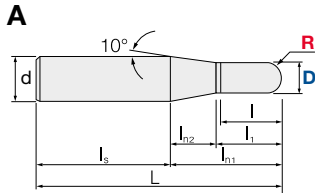
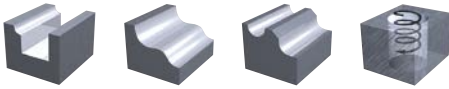

Carbide Micro Grain	TH45+ Nano-PVD Coating	Rake Angle Positive
-------------------------------	----------------------------------	-------------------------------



R	± 0.005
D	0/-0.01
d	h5

ID Code	Item No.	Z	D	R	l	l ₁	l _{n1}	l _{n2}	L	L _s	d	Type
EP 255	EPBT-2010	2	1	0.5	1.5	2.5	11	8.5	50	39	4	A
EP 256	EPBT-2020		2	1	3	4	15.3	11.3		34.7		
EP 257	EPBT-2030		3	1.5	4.5	5.5	14	8.5		56		
EP 258	EPBT-2040		4	2	6	7	12.7	5.7		57.3		
EP 259	EPBT-2050		5	2.5	7.5	8.5	11.3	2.8		68.7		
EP 260	EPBT-2060		6	3	9					81		
EP 261	EPBT-2080		8	4	12				100	88	8	B
EP 262	EPBT-2100		10	5	15					85		
EP 263	EPBT-2120		12	6	18					92		
										110		

Nano-PVD Technology

EPHT | Epoch Hard TH-Coating

V max High Speed	 Semi-Finishing	 Finishing	HRC 70	No. of Teeth 4	No. of Teeth 6
----------------------------	---	--	------------------	--------------------------	--------------------------



A

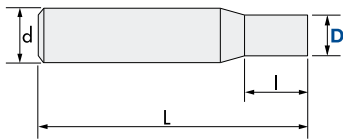

B

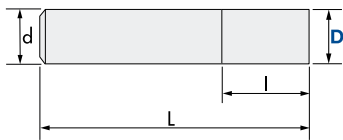

Carbide Micro Grain	TH45+ Nano-PVD Coating	Rake Angle Negative
-------------------------------	----------------------------------	-------------------------------

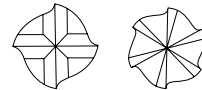

D1–D6	0/-0.015
D8–D20	0/-0.02
d	h5

ID Code	Item No.	Z	D	l	L	L _s	d	Type	
EP 244	EPHT-4010	4	1	3.5	60	56.5	6	A	
EP 264	EPHT-4015		1.5	5		55			
EP 245	EPHT-4020		2	7		53			
EP 265	EPHT-4025		2.5	8		52			
EP 246	EPHT-4030		3	10		50			
EP 247	EPHT-4040		4	12		48			
EP 248	EPHT-4050		5	15		45			
EP 249	EPHT-6060	6	6	15	45	8	B		
EP 250	EPHT-6080		8	20	75			55	
EP 251	EPHT-6100		10	25	80			55	10
EP 252	EPHT-6120		12	30	100			70	12
EP 253	EPHT-6160		16	40	110			70	16
EP 254	EPHT-6200		20	45	125			80	20

Always up to date: Please check our P50 QuickFinder



www.mmc-hitachitool-eu.com/quickfinder

Product Range

Solid Carbide End Mills



Indexable Milling Tools



WHNSB Drills



Milling Chucks



Distributed by:

MMC Hitachi Tool Engineering Europe GmbH

Itterpark 12 · 40724 Hilden · Germany · Phone +49 (0) 21 03-24 82-0 · Fax +49 (0) 21 03-24 82-30
E-Mail info@mmc-hitachitool-eu.com · Internet www.mmc-hitachitool-eu.com
© 2015 by MMC Hitachi Tool Engineering Europe GmbH · 2nd Edition · Printed in Germany